

Welcome!



**Thank you for purchasing the
Cricut Expression® 2 machine!**

Just follow the numbered cards in this
Welcome Packet to get started. You will be
creating your first project right away!

Use the Cricut Expression® 2 machine to cut shapes and fonts out of paper, vinyl, fabric, and other materials. It's a simple way to make handmade cards, personalized gifts, home décor, scrapbook layouts, or any other creative ideas you have!

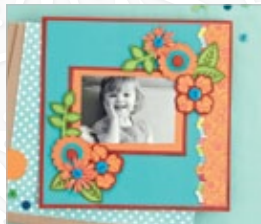

1 Getting Started

What you'll need to make your first project.

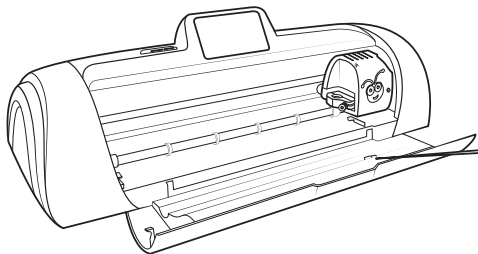

Cricut Expression® 2 machine

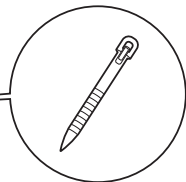

Stylus

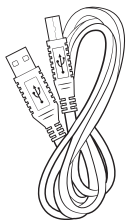

USB cable
(For use with Cricut
Craft Room®)

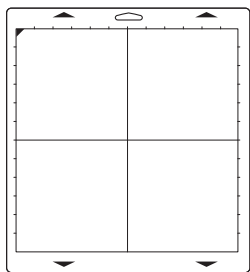

Cutting mat

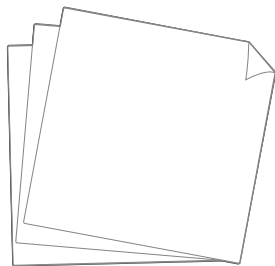

Paper
(not included)

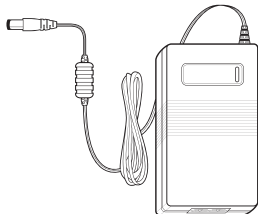

Power supply

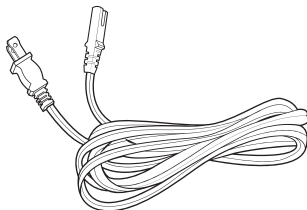

Power cord



Cutting blade
assembly



Set Up Machine

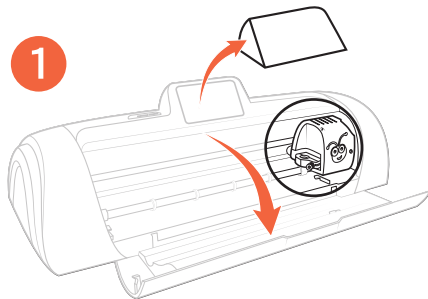

1 Remove silicone screen protector and open lid.

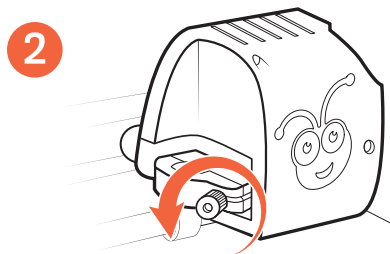

2 Turn screw to loosen.

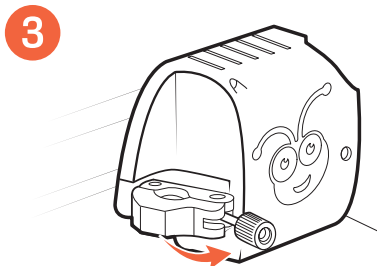

3 Move screw to right to release swing arm.

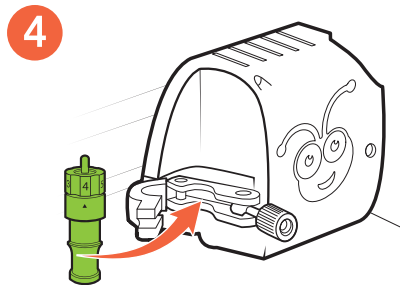

4 Insert cutting blade assembly into carriage.

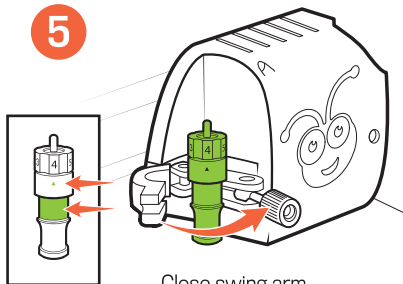

5 Close swing arm.

Ensure the middle of the blade housing is in the swing arm and the arrow is facing forward.

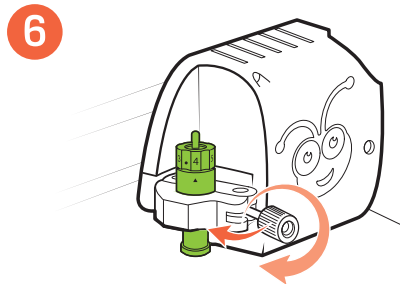

6 Move screw to left and tighten to secure.

7

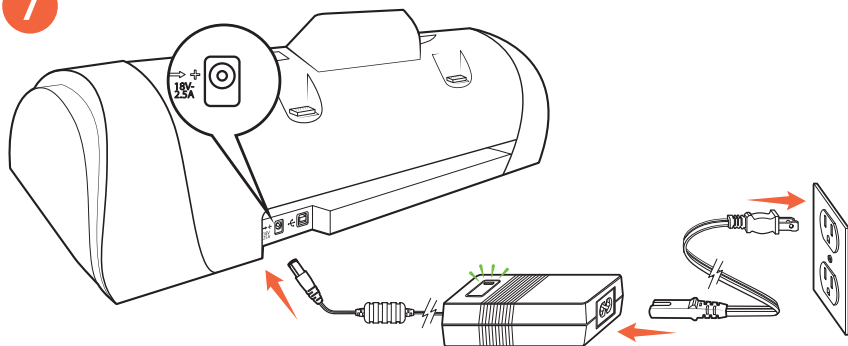

Assemble power supply and plug in machine.

8

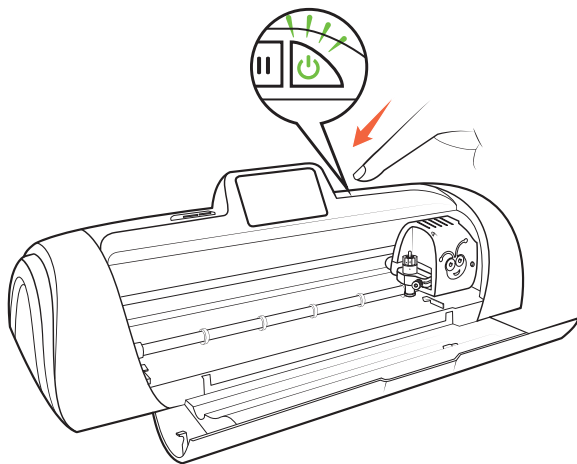

Press power button to turn on machine.

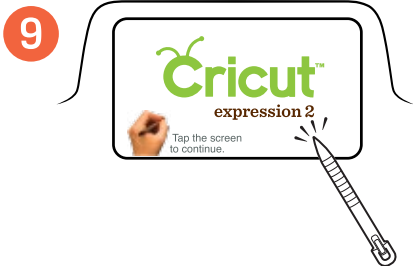

Tap screen to continue.

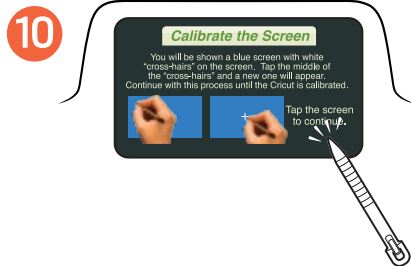

Tap screen to calibrate.

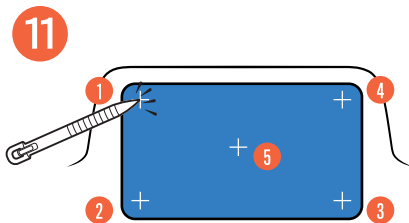

Tap the middle of the crosshairs and a new one will appear. Continue until calibrated.

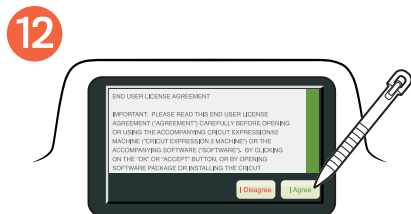

Read End User License Agreement. Tap **I Agree** to continue.



- 1 Tap checkbox if desired.
- 2 Tap check mark to continue.



You will now be on the Cricut Expression® 2 design home screen.

2 Machine Exploration

Explore your machine features
and make your first cut.

Thank
You

(Paper not included.)



Load Mat

1

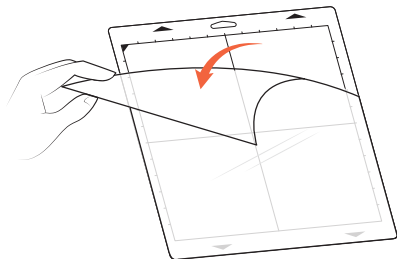

Remove clear plastic cover. Save for storage.

2

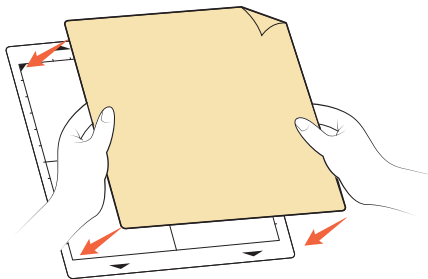

Place paper (not included) on mat inside grid.

3

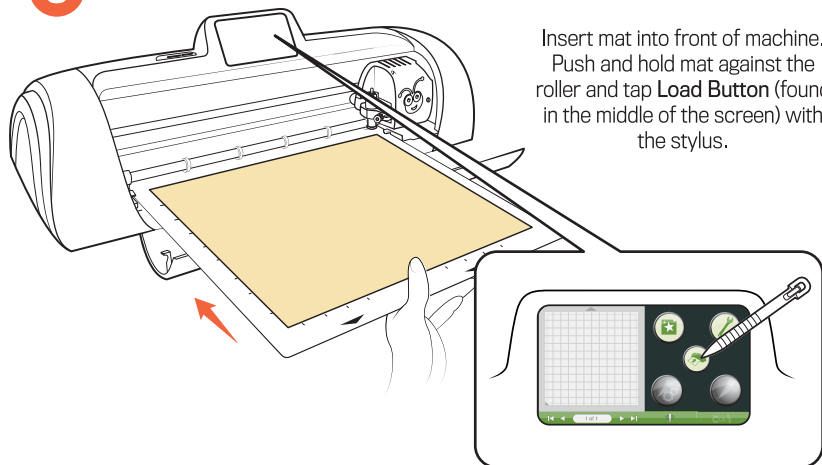

Insert mat into front of machine.
Push and hold mat against the roller and tap **Load Button** (found in the middle of the screen) with the stylus.



Image Exploration

1

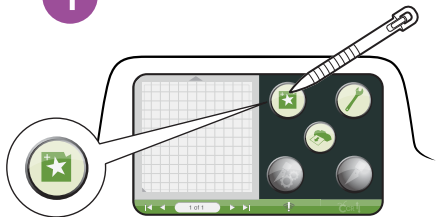

Tap **Image Button** on the Home Screen.

2

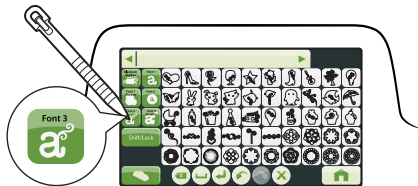

Tap **Font 3** on the Image Screen to view more images.

3

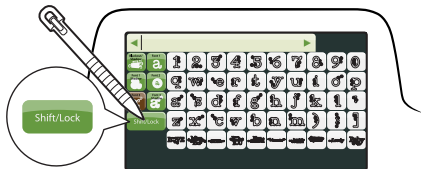

Tap **Shift/Lock** on the Font 3 images screen to view even more images.

4

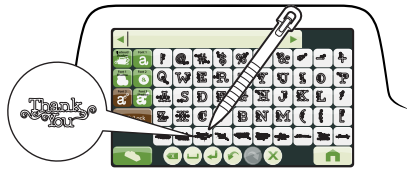

Tap the **Thank You** image.

5

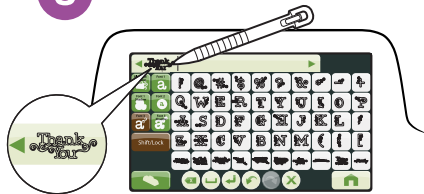

The **Thank You** image is now in the Image Queue.



1

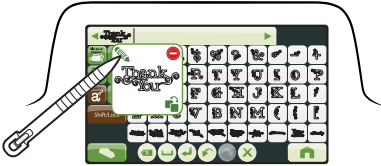

Tap the **Thank You** image in the Image Queue to show the pop-up window. Tap the **Edit Icon**.

2



Tap the **Size Button** on the Image Editor Screen.

3

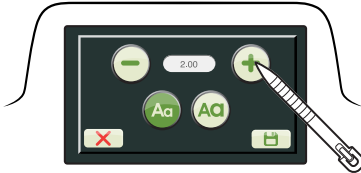

Change the size to 3 by tapping the plus or minus buttons.

4

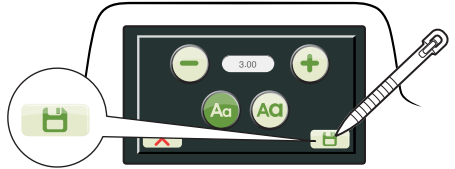

Tap the **Save Button**.

5



Tap the **Save Button** on the Image Editor Screen.

6

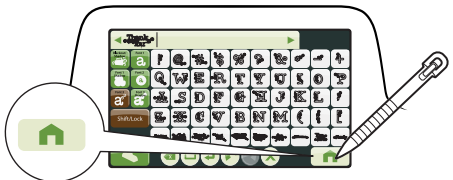

Tap the **Home Button**.



1

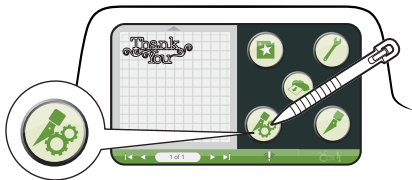

Tap the **Cut Settings Button**.

2

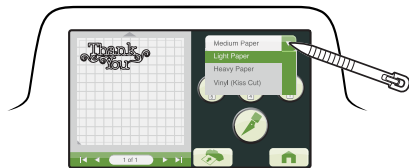

If needed, tap the **Arrow Button** to choose what type of material you are cutting.

3



Change the blade depth to match the number in the drop down menu. Twist the top of the blade assembly so the number lines up with the arrow.

4

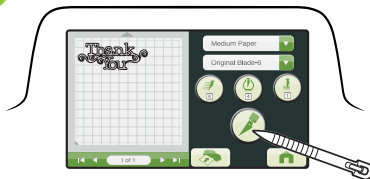

Tap the **Cut Button**.



Remove Your First Cut!

1

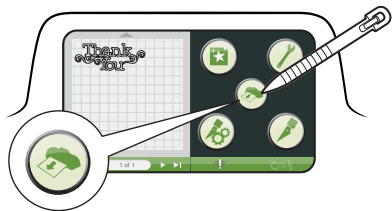

Tap the Unload Button.

2

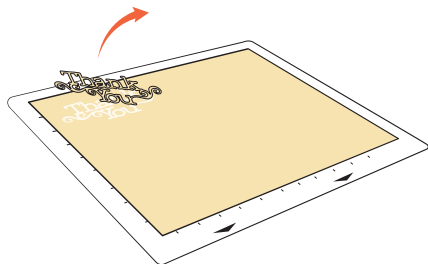

Remove **Thank You** image and all paper.

3

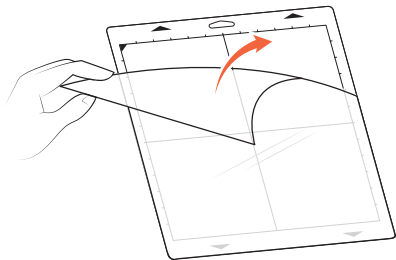

Replace clear plastic cover for storage.

4

**Thank
You**

Congratulations!

You just finished exploring and making your
first cut with the
Cricut Expression® 2 machine.